



Published on *Haala Industries* (<https://www.haala.com>)

[Home](#) > Safety Grates Royal Style

Safety Grates Royal Style

Title:

SG1841R

Part No.

SG1841R

Safety Grates are designed to cover the sloped round pipe end section of an inlet or outlet pipe and prevent large debris from passing through while also restricting access to the pipe system. Designed around MN DOT Standard Plate 3022C, design option 2 for round pipe end sections. Grates are offered with three options for mounting: Top mount tabs, swinging side mount tabs or a dropped end bar.

- Solid bar design for durability and long life
- Typical bar c/c is 12"-18" one direction
- Galvanized steel construction. Can be made from aluminum or stainless steel.

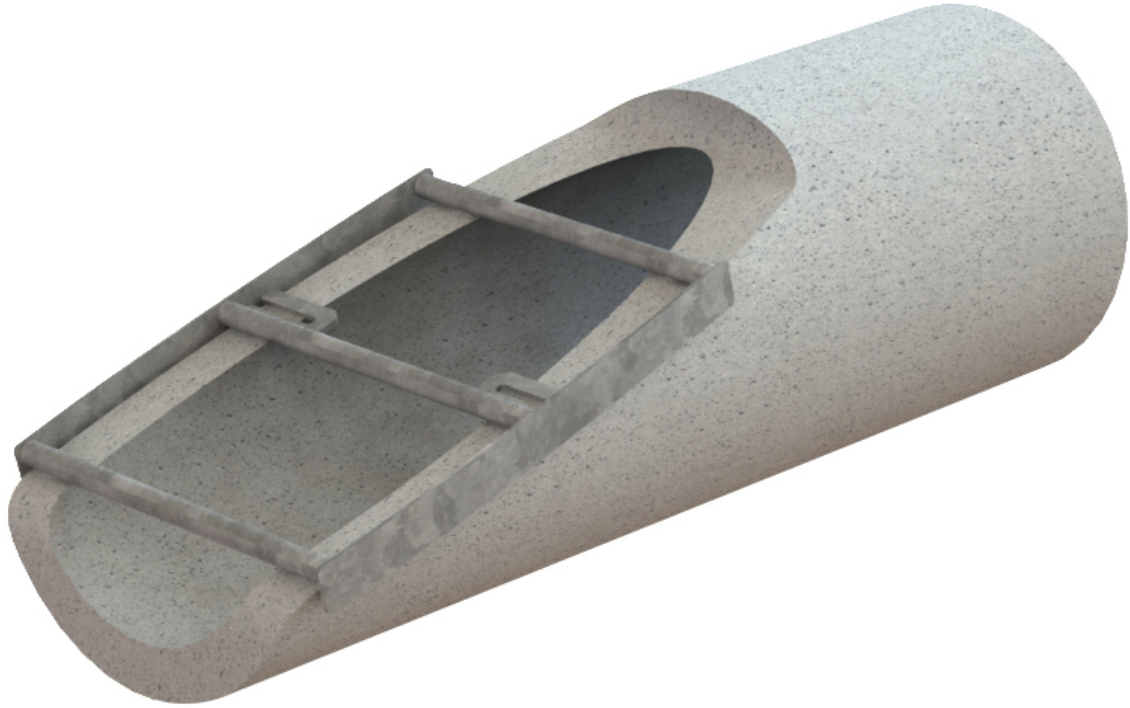

SG1841R ▼

[Contact us for a Quote](#) [1]

Physical weight:

0 lb

Physical dimensions:

0 × 0 × 0 in

Related products:

[Safety Grates](#) [2]

SG1241A-1 ▼

Add to cart

Dealer-only purchase:

No

Shipping method:

[Freight](#) [3]

Size:

[18](#) [4]

Slope:

[4:1](#) [5]

Bar Spacing:

[12](#) [6]

Thickness:

[1 1/2](#) [7]

Material:

[Galvanized Steel](#) [8]

Source URL: <https://www.haala.com/products/safety-grates-royal-style>

Links

[1] <https://www.haala.com/information-request?list=SG1841R>

[2] <https://www.haala.com/products/safety-grates>

[3] <https://www.haala.com/shipping-method/freight>

[4] <https://www.haala.com/royal-style-safety-grates-size/18>

[5] <https://www.haala.com/royal-style-safety-grates-slope/41>

[6] <https://www.haala.com/royal-style-safety-grates-bar-spacing/12>

[7] <https://www.haala.com/royal-style-safety-grates-thickness/1-12>

[8] <https://www.haala.com/royal-style-safety-grates-material/galvanized-steel>